

28th April 2023

Commencement of Works – Delay

Firstly, Starfish Construction would like to offer their sincere apologies for the impact caused by the current delay. We understand the consequences a delay can have on residents and leaseholders, and we can assure you that we are working hard to commence work as soon as possible. We thank all residents and leaseholders for their patience and cooperation during this time.

Secondly, as we have informed you in previous communications, Network Rail require information from Starfish Construction before work can begin. The information is required to enable Starfish Construction to use access equipment such as mast climbers within a close proximity to the Network Rail line. The Starfish Project Team have been working hard alongside various other Organisations to obtain this information, and we are pleased to inform you that the information will be submitted to Network Rail by close of business today. On receipt, Network Rail can take upto 20 working days to process the information. Therefore, as soon as Starfish receive the necessary permissions, we are prepared to mobilise the set-up of scaffolding and access equipment at Block 1. Further information will be communicated to you once permissions from Network Rail are received.

Pedestrian Walkway

Starfish Construction are committed to the safety of all residents and visitors here at St Georges Island. Site Traffic from both Operatives and Vehicles will increase as works progress, and we will be implementing measures such as a pedestrian walkway to minimise the risk and disruption to the public. From week commencing 8th May, work will begin to implement the Pedestrian walkway. The pedestrian walkway route is shown in red on the below drawing.

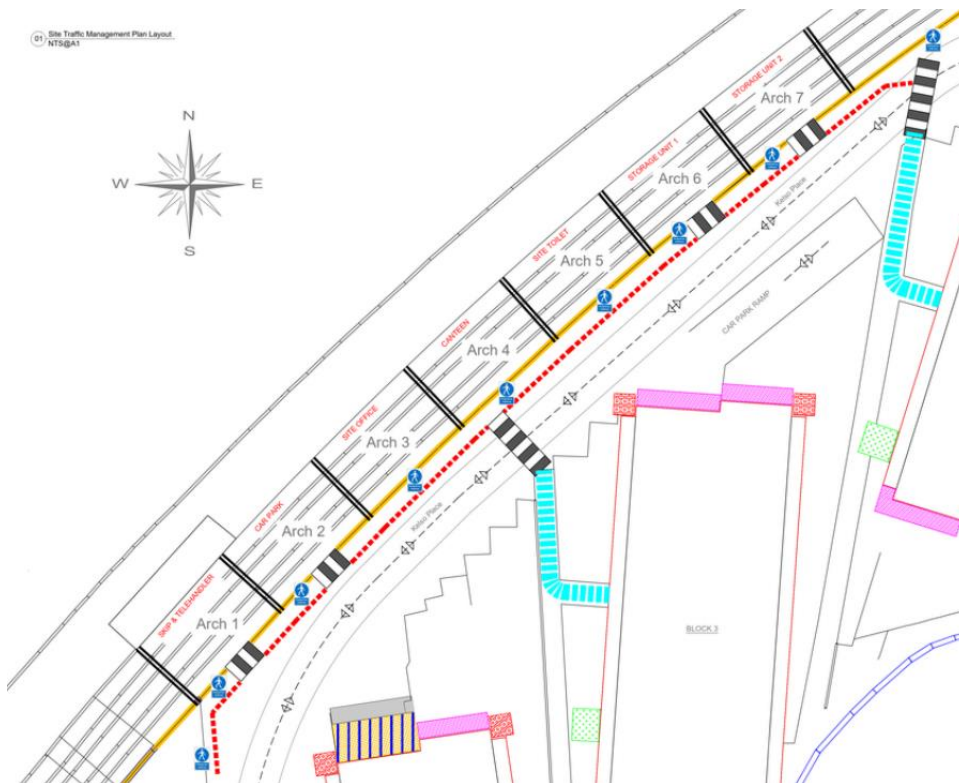

Disruption Notice - Delivery of Containers

On 15th May 2023, we will be receiving a delivery of 3 Containers. Due to the size of the containers, and the delivery vehicles required, we would like to advise you that short delays may occur throughout the day. We offer our apologies in advance for the disruption.

AED – Automated External Defibrillator

We are delighted to advise you of the availability of an Automated External Defibrillator (AED) which is based in the Site Office here at St Georges Island. The AED has been purchased by Starfish Construction and we are extending the availability of its use to all at St Georges Island.

Please Note: The AED will be accessible during Site office hours only.

AED Explained:

An **Automated External Defibrillator (AED)** is a portable lifesaving device that can give a casualty's heart an electric shock, when it has stopped beating normally in a sudden cardiac arrest.

A defibrillator works by checking the casualty's heart rhythm once the defibrillator pads are placed on their chest and giving them a shock if needed.

By using a defibrillator before an ambulance arrives, you can significantly increase someone's chance of survival.



Should you have any questions about the works, please don't hesitate to contact Resident Liaison Officer, Melissa Buckley via email on mbuckley@starfishconstruction.com or via telephone on 07944 304 708.